

DEVELOPED BY GOLDEN HOMES



VOLLEYBALL COURT



SKATING RING



CRICKET PITCH



TENNIS COURT



OPEN AIR THEATRE



BASKETBALL COURT



OPEN BADMINTON COURT



P50500050049



GOLDEN VISTA

by

GOLDEN HOMES

Your Dream, Our Passion...

2&3 BHK SMART HOME FOR
ECO LUXURY SPORTIER LIFESTYLE



WING-B

WING-A

ABOUT PROJECT :

Golden Homes is a brand with an aim to provide luxurious and Quality Life style.

After successful completion of our dream project Luxury Villas at Shankarpur, we are launching 2&3 BHK-Smart homes for eco luxury sportier lifestyle with the name 'Golden Vista', spread in 2.25 acres of land, consisting two G+11 towers and open space with 25+ world class amenities like the calm and clean swimming pool, the lavish club house and the children's play area. And adjacent 35000 sq.ft designed for outdoor sports. We have everything that exhilarates your energy and uplifts your standard of living.

Experience a wonderful and complete lifestyle with all the convenience just for you and your family, only at Golden Vista by Golden Homes.

AERIAL NIGHT VIEW

AMENITIES :

- WIDE INTERNAL ROAD

- C.H. ROOF TOP SWIMMING POOL



- OPEN PLAY AREA FOR CHILDREN

- VOLLEYBALL COURT

- SKATING RING

- OPEN BADMINTON COURT \ TENNIS COURT



- OPEN AIR THEATRE

- SENIOR CITIZEN SITTING AREA

- CRICKET PITCH

- INDOOR PLAY AREA (CHESS, CARROM)



- INDOOR GYM



**Fully Ventilated
Apartments**



Grand Entry Gate



**Club
House**



**Video Door
Phone**



**Community
Hall**



Temple



**Yoga & Meditation
Area**



**Common EV
Charging Point**



**Generator Backup
for Common Area
Lights +1 Lift**



**Visitor Car
Parking**



Garden



**24*7 Water Supply
(Corporation & Ground Water)**



**Paved
Pathway**



**Allotted One Car
Parking**



**24*7 Security with
CCTV Surveillance &
Compounded Society**



**Fire Fighting
Equipments**



**Rain Water
Harvesting**



**Sewage Treatment
Plant**



GROUND FLOOR PLAN

STRUCTURE

- Earthquake Resistance RCC Frame Structure.

KITCHEN

- Kitchen Granite Platform with one Stainless Steel Sink.
- Designer Dado Tile Up to 2FT. above Kitchen Platform.
- Provision for Exhaust Fan.
- 2x4 Vitrified Tiles Flooring.

ELECTRIFICATION

- Concealed Copper Wiring with Circuit Breakers ISI Marked of Polycab / RR Cable or Equivalent Brand.
- Adequate Electrical Points with Modular Switches of Legrand, Wipro or Equivalent Brand.
- TV Point in Living Room.
- Aqua Guard Point in Kitchen.
- Chimney Electric Point in Kitchen.
- Geyser Point in all Bathrooms.
- AC Points in all Bedrooms and Living Room.
- Wi-Fi Cabling up to Living Area.

DOOR & WINDOWS

- Wooden Door Frame for Main door with Laminated Door.
- Powder Coated Aluminium Sliding Windows with Mosquito Net.
- Flush Door in Toilet and Balcony with RCC Frame.
- Flush Door with Wooden Frame for Bedrooms.
- Granite Window Sill.
- M S Safety Grill for Regular Windows.

TOILET/BATHROOM

- Toilet / Bathroom Sanitary Fittings of Jaguar or Equivalent Brand.
- CP fittings of Jaguar or Equivalent Brand.
- Anti-Skid Floor Tiles in Toilet.
- 4x2 Toilet Wall Tiles Up to 7 FT. Height Standard Brand.
- Hot and Cold Diverter with Overhead Shower.

INTERNAL FINISH

- 4x2 Vitrified Tiles Flooring Of Standard Brand.
- 2x2 Anti-Skid Flooring in Terrace / Balcony.

PAINTING

- Inside Wall OBD Painting with Putty and External Paint with ACE / WEATHER SHIELD or Equivalent.

RAILING

- S.S. Glass Railing in Balcony.

PLUMBING

- Plumbing Branded - ISI Marked.

WATERPROOFING

- Proper Waterproofing for Bathrooms, Utility Area and Terraces.

SPECIFICATION

TYPICAL FLOOR PLAN - 2ND TO 11TH

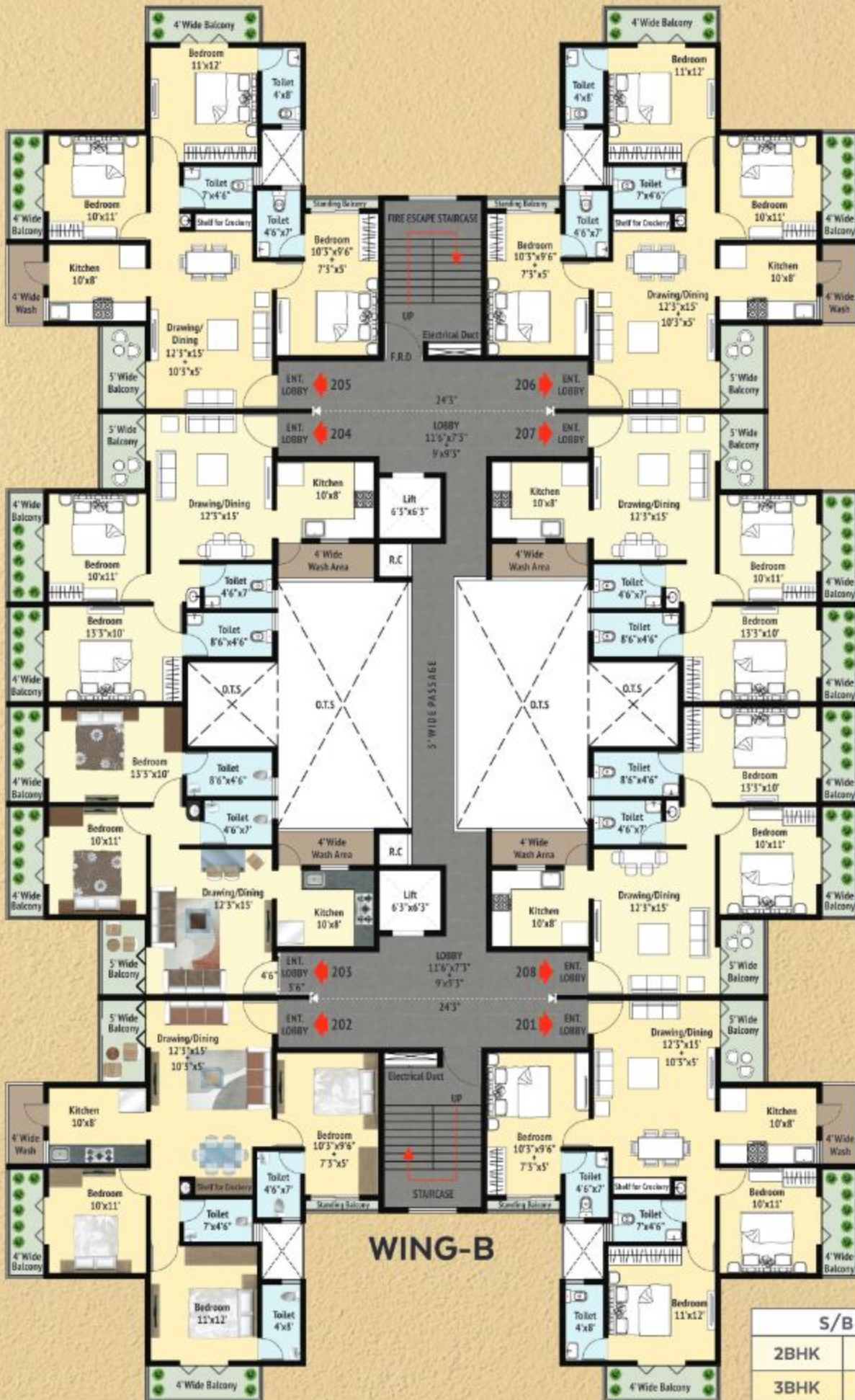

WING-B



S/B AREA	
2BHK	1140 SQ. FT
3BHK	1360 SQ. FT

2BHK



1140 SQ. FT.



3BHK



1360 SQ. FT.





WING-B

WING-A

C.H. Roof Top
Swimming Pool

Multipurpose Court
Basketball/Volleyball/Skating

Fitness

Club
House

Toddler Play Area/
Green Gym

Open Air
Theatre

Seating
Area

Grand Entry Gate

Creche

Fully Ventilated Apartment

Tennis Court

Cricket Pitch

Compounded
Society

Open Play Area
for Children

Allotted Car Parking

24x7 Security

LOCATION MAP



Scan For Location

For Walkthrough and more information :



@goldenhomesnagpur



GOLDEN HOMES INFRASTRUCTURES

Architect
Ar. Chandrashekhra Giripunje

Structural Engineer
Er. Nikhil Gangamwar

• OFFICE ADDRESS •

3rd Floor, Plot No 107, Vivekanand Nagar, Near Sai Mandir Chowk, Wardha Road, Nagpur - 440015.

• SITE ADDRESS •

Golden Vista, Kh 136/2, Ph No - 38, Behind St. Vincent Pallotti School Besa, Pipla, Nagpur

✉ sales@goldenhomes.org.in
🌐 www.goldenhomes.org.in

Contact -

Disclaimer : This Brochure is purely a conceptual presentation and not a legal offering. The developers reserve the right to alter and make any changes in the elevation, plans, area and specifications etc as deemed fit.