

Rera No.: P50500046199

*Suvarna
Villa*
3 BHK MODERN FLATS

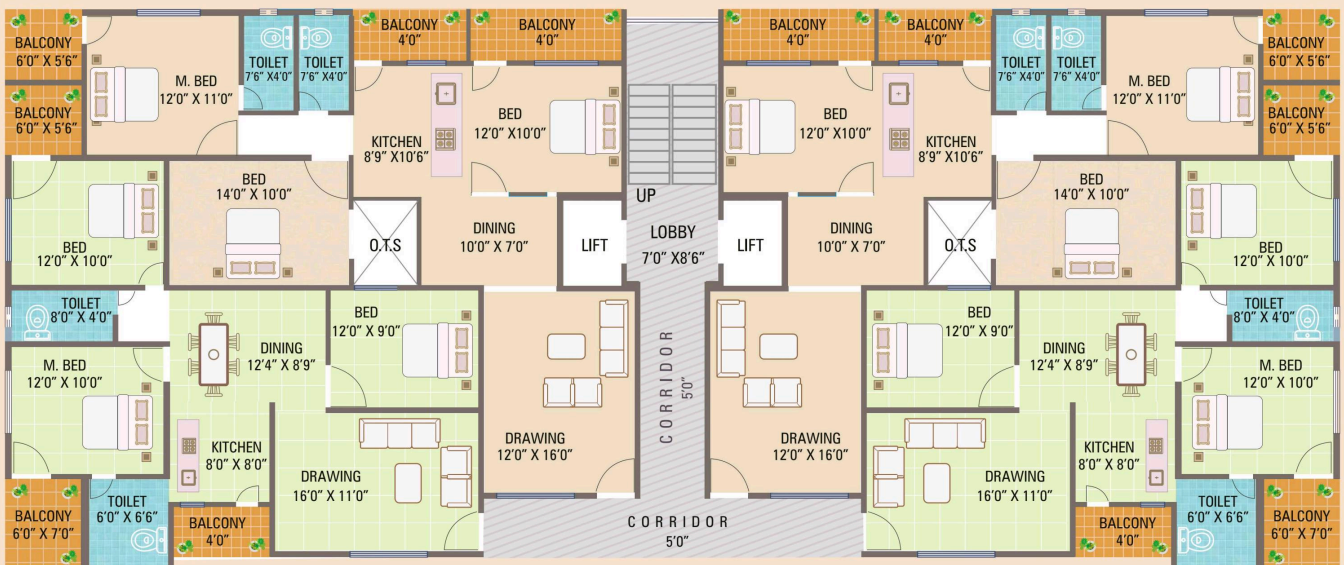



3 BHK A

Flat No.	Area
101/ 201/301/401/501/601	1305 SQ. Ft.
102/ 202/302/402/502/602	1410 SQ. Ft.



3 BHK B

Flat No.	Area
103/203/303/403/503/603	1410 SQ. Ft.
104/204/304/404/504/604	1305 SQ. Ft.

STATE OF THE ART FACILITIES



SOLAR SYSTEM

For Staircase, common external light & Parking Light.



Internal: P.O.P for drawing room and two bedrooms. Cement putting + Acrylic emulsion paint for all room

External: The buildings has paint in water proof paint



LIFT

2 Lifts with Solar power backup.



WATER SUPPLY

24x7 Water Supply from Overhead Tank.



PARKING

To every flat allotted Mechanical Car Parking.



TERRACE

Waterproof coating Flooring at terrace.



CCTV

Area under surveillance.



WI-FI SYSTEM

Wi-fi Router provided.



Safe and Secure Life



Modern Style Kitchen



Spacious Terrace



Individual Parking Space

Note:

- (a) Stamp duty and charges for agreement and send it will be borne by flat purchaser as per government rule.
- (b) Water meter, electric meter transformer and cable will be borne by flat purchaser.
- (c) GST will be paid by flat purchaser as per govt. norms.
- (d) Other terms and condition will be applicable as per agreement.
- (e) Charges on plans right reserved under architect.
- (f) Extra work charges should be paid by purchaser in advance.
- (g) This brochure is concept full in nature and binomial legal document or offering developers reserve the right to add or delete after any design element of the building

SPECIFICATIONS



STRUCTURE

R.C.C. Framed Structure
By Structural Engg. **P.S. Patnkar**



WALL BRICK

AAC bricks Wall 15 or 11.5 opr 10 cm
thick as per architect drawing.
By Structural Engg.



FLOORING

Vitrified tiles for all rooms.



DADO: Glaze tiles in Bath/WC/Toilet/
Kitchen. (A) Bath and Toilet (B) Over
kitchen otta & Wash Basin **Full Heights**.



PLASTER

Smooth funty finish plaster
to outer and Inner **punning finish**.



KITCHEN OTTA

Modular kitchen with **Bajaj Trolley** & stainless steel
sink. Granite top surface with over
head chimney.



LOFT

One loft 0.45m shall be provided in
kitchen and bedroom only.



MAIN DOORS

TATA Pravesh steel decorative door with safety
lock system having wooden appearance.
Others Doors : Cement frame with veneer
finish flush door.

Others Doors : Cement frame 5" Width [Alluminium]
with veneer finish flush door.



WINDOWS

Aluminum glaze window
powder coated with safety MS grill.



PLUMBING

Sufficient tab in Toilet (with Pillar Cock &
Diverter) & kitchen With **Jaquar[essco]** plumbing fitting
24 hours water supply from overhead Water tank.
(All Sanitary ISI fitting are in white colour.)



ELECTRICAL

Concealed type electric ISI fitting A.C. Point
in Hall & Two Bed Room. (2 Light point, 1 Fan
point, 1 Plug shall be provided Shall be provided with
Anchor Modular Switches & Board in each rooms.
1 point each in Toilet & passage shall be provided.
All circuit has into meter board.

A Project by:



GLOBE
BUILDERS & DEVELOPERS

📍 Royal Park, Harpur, Behind
Priyadarshani Bhagwati Engineering
College, Umred Road, Nagpur

☎ 7709913435, 9822718155

✉ info@globeassociates.in

🌐 www.globeassociates.in

SUCCESSFULLY COMPLETED PROJECTS:



Manas Palace



Anishka Palace



Rising Heights



Anirudha Residency

Structure Consultant:
P. S. Patankar

Planing Consultant:
Satish Ramteke

Disclaimer: This brochure is conceptual and not a legal offering. The promoter reserves the right to change, alter, add, or delete, any of the specifications mentioned herein without prior permission or notice.