



# MEHER ganga

CONVENIENCE WITH LUXURY  
ONLY FOR YOU



# Welcome

To the new world

Relaxing and quiet surrounding where you can hear your own emotions of relaxation And achievement. A perfect place to enjoy life. Beautiful Topography surroundings with connectivity and comfort. The areas are suitable for investment and for those looking to boost their investment in lesser time this would be the right choice. The area is connected with a flowing river, Mountain ranges and picturesque surrounding and all types of urban comfort.





A Little  
*World*  
Behind the wall

With best location and organised spacious shops and stores for your dream project, live closer to the office rather than live above the workplace. The apartment offers unrestricted view of surrounding. Elegant designed complement the clean open and modern architecture. The perfect place to live just the way it should be.



Where  
**Joy**  
Resides

When we design homes with your happiness in mind, the outcome always exceeds expectations.

Meher Ganga is no different.

It is a spectacular gated community that brings you everything that sums up a blissful life. Right from grand entrances to usher in new beginnings to landscaped areas for warm vibes. From elegant 2&3 BHK residences for luxurious living to premium amenities for plentiful leisure. From close community for new friendships to thoughtful additions for added value. Everything is in place to offer endless joy!





# Cloud

of your imagination

Just feel free to come to the top  
& enjoy the hassle-free life

Function is at the heart of form at Meher Ganga. The simple yet classy façade is an ideal front for the tasteful living spaces inside designed to nurture quality time with your loved ones. The grand entrance welcomes you into a world of three sleek towers that wrap within them the delights of a like-minded community.



GROUND FLOOR PLAN

WING - A

GROUND FLOOR PLAN

WING - B

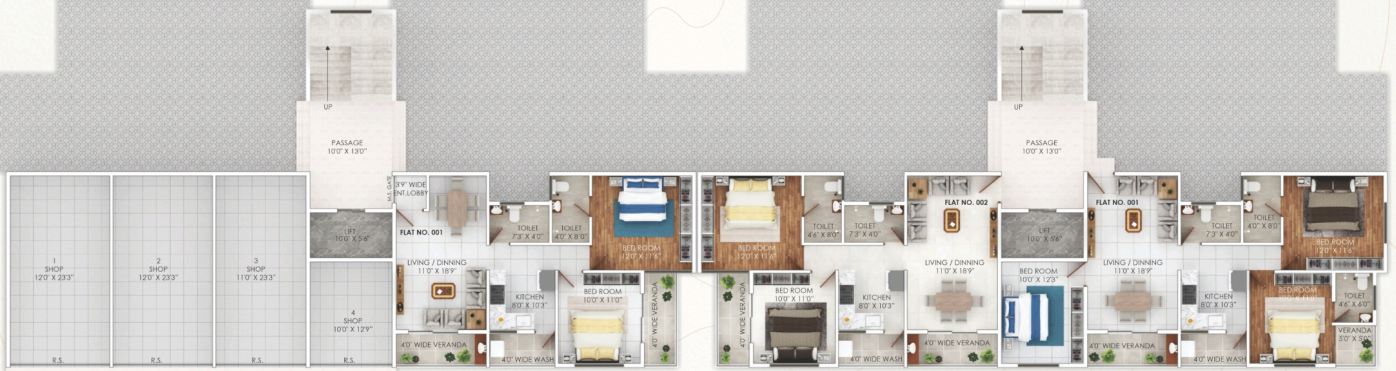



TYPICAL 1ST TO 7TH FLOOR PLAN

WING - A

TYPICAL 1ST TO 7TH FLOOR PLAN

WING - B



TYPICAL 1 ST FLOOR PLAN

WING - C

TYPICAL 2ND TO 7TH FLOOR PLAN

WING - C





ISOMETRIC VIEW



Key Plan



TYPICAL 2ND TO 7TH FLOOR PLAN

ISOMETRIC VIEW



Key Plan



TYPICAL 2ND TO 7TH FLOOR PLAN

TYPICAL 1ST TO 7TH FLOOR PLAN

WING - D



ISOMETRIC VIEW



Key Plan



TYPICAL 1ST TO 7TH FLOOR PLAN







## Leisure Amenities



Podium Garden



Swimming Pool



Gym Area



Indoor Games



Multipurpose Hall



Children's Play Area



Jogging Track



Yoga Room

## Value Additions

- An inviting Entrance Gate
- Secured Gated Community
- 24 x 7 Security with Security Cabin
- CCTV Enabled Campus
- Allotted Parking
- Power Back-up for Common Areas
- 1 Automatic Elevators for Each Tower
- 24 Hours Water supply
- Elegant Entry Lounge
- Rain Water Harvesting
- Underground Cabling of Wires
- Efficient Planning
- Well-ventilated & Breezy Infrastructure
- Wide Common Space
- Easy Maintenance Design in Common Area

Life is cool by sky pool.  
You are only swim away  
from a good mood.





## SPECIFICATIONS

Part of the Fortune Select lineage, Meher Ganga offers exclusivity a notch above. Only the best material specifications, premium quality brands and superior craftsmanship ensures a stellar home for you and your family!

**PLUMBING**  
• ISI Mark Full CPVC, UPVC, SWR Pipe Fittings  
• PVC Pipe for Soil pipe & Rain Water pipe



# MEHER ganga

CONVENIENCE WITH LUXURY  
ONLY FOR YOU



**STRUCTURE**  
• Earth-quake resistant,  
• RCC framed structure



**DOORS & WINDOWS**  
• Main Door - Metallic secure Door  
• Other Door - Flush door & RCC frame  
• Toilet Door - Waterproof door with RCC frame



**ELECTRICAL**  
• Concealed electrical fitting with ISI Wire and modular switches  
• Sufficient power outlet and light points provided



**BED ROOM & LIVING ROOM**  
• Vitrified Tiles flooring  
• Cable TV connections in Living Room  
• AC Point Hall & Master Bedroom  
• POP Hall & All Bedroom



**KITCHEN**  
• Granite top with S.S. Sink, Aqua guard point  
• Semi Modular Kitchen



**LIFT & PARKING**  
• LIFT With ARD  
• Spacious ample car & 2 wheeler Parking



**BATHROOM**  
• Antiskid Tiles flooring  
• Washbasin  
• Standard make fittings & premium sanitary ware  
• Designer dado up to 7'  
• Hot & Cold water connection



**PAINTING**  
• Internal - Emulsion Paint with Full Putty  
• External - Plastic Emulsion Paint





# Location Map

Not to scale



## NEAREST PROXIMITY



**Site Address:** Plot No. 6,28,&29, Rajshri Nagar, Beltarodi Road, Nagpur